

The actual distance between the rivers on the north line of Winslow is found to be 840 rods. So that the rivers are set laid down on this far enough apart by 88 rods.
Charles Hayden.

The annexed plan represents an actual survey of a township of land lying on the east side of Kennebec river, two miles and one half to the northward of Fort Halifax; and two miles and one half to the southward of said fort: the whole township contains eighteen thousand, two hundred acres, ponds and Sebasticook river included, and is bounded as follows, viz: beginning on the east side of Kennebec river at Hamlock tree, extending on the bank of the river, and one rod west northwest of a large rock, and two miles and one half of a mile one north north east course from Fort Halifax: from said tree to run east southeast five miles to a Beech tree marked; then running south south west five miles and twenty-eight poles to a red oak marked; then running east north west to Kennebec river, being about six miles and two hundred and thirty-six rods, to a red oak tree standing on the bank of the Kennebec river; then running northerly up said river, on the shore 1/2 m, five miles and twenty-eight poles, to the bounds first mentioned. The external lines and the geography of the east side of the river were carefully taken and run, and is laid down by a scale of eighty poles to an inch.

Dr. John McKee - Surveyor.

A true copy per me, Palham Winslow.

See Book E 2003
Page 134
10-17-03

Boston 1766.
David Jeffries Clerk to the Proprietors
of the Kennebec Purchase from the
Late Colony of New Plymouth.

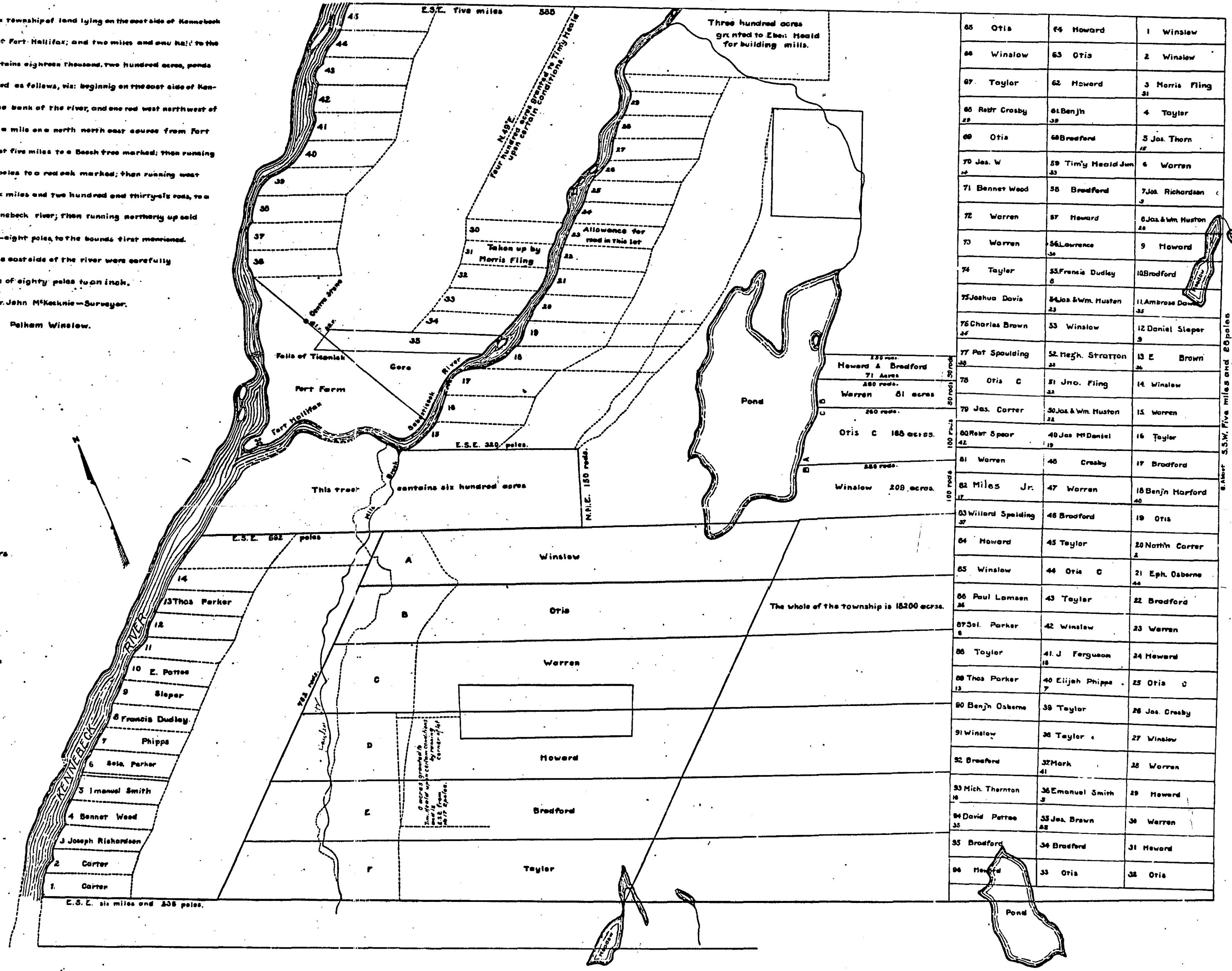
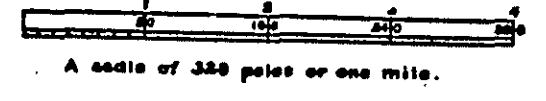

65	Otis	64	Howard	1	Winslow
66	Winslow	63	Otis	2	Winslow
67	Taylor	62	Howard	3	Morris Fling
68	Rebr Crosby	61	Benjn	4	Taylor
69	Otis	60	Bradford	5	Jos. Thorn
70	Jas. W	59	Tim'y Heald Jun	6	Warren
71	Bennet Weed	58	Bradford	7	Jos. Richardson
72	Warren	57	Howard	8	Jos & Wm. Huston
73	Warren	56	Lawrence	9	Howard
74	Taylor	55	Frencis Dudley	10	Bradford
75	Joshua Davis	54	Jos & Wm. Huston	11	Amrose Dan
76	Charles Brown	53	Winslow	12	Daniel Slep
77	Pat Spaulding	52	Hegh. Stratton	13	E. Brown
78	Otis C	51	Jmo. Fling	14	Winslow
79	Jas. Carrer	50	Jos & Wm. Huston	15	Warren
80	Rear Spear	49	Jos M'Daniel	16	Taylor
81	Warren	48	Crosby	17	Bradford
82	Miles Jr.	47	Warren	18	Benjn Marford
83	Willard Spalding	46	Bradford	19	Otis
84	Howard	45	Taylor	20	Nath'n Carrer
85	Winslow	44	Otis C	21	Eph. Osborne
86	Paul Lamsen	43	Taylor	22	Bradford
87	Sol. Parker	42	Winslow	23	Warren
88	Taylor	41	J. Ferguson	24	Howard
89	Thos Parker	40	Eijah Phipps	25	Otis C
90	Benjn Osborne	39	Taylor	26	Jos. Crosby
91	Winslow	38	Taylor	27	Winslow
92	Bradford	37	Mark	28	Warren
93	Mich. Thornton	36	Emanuel Smith	29	Howard
94	David Perree	35	Jos. Brown	30	Warren
95	Bradford	34	Bradford	31	Howard
96	Howard	33	Otis	32	Otis

about 5.5 W. five miles and 20 poles

BK4 P6 65 1-1-1766

PLAN NO 17